

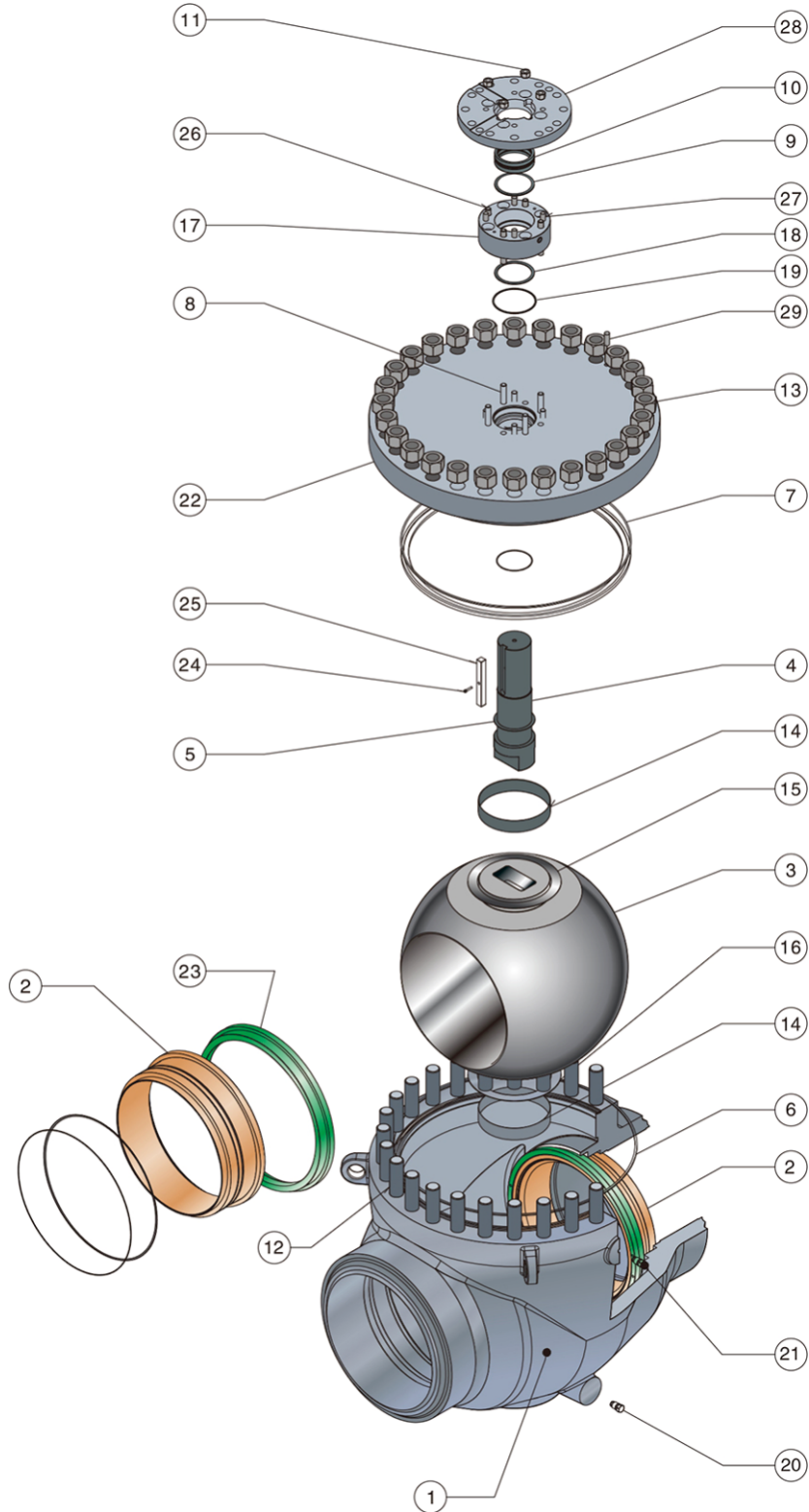

MODEL NO.:EFC-02BV1B5
Size:2" ~ 36" (DN50 ~ DN900)
Class:CL150 ~ CL2500

TOP ENTRY BALL VALVE



The material is according to ASTM Standard.
 Model Denote:EFC=Elite Flow Control | 02=Size in inch | BV=Ball Valve | 1=150Lb | B=BW End | 5=Top Entry

MODEL NO.:EFC-02BV1B5
Size:2" ~ 36" (DN50 ~ DN900)
Class:CL150 ~ CL2500

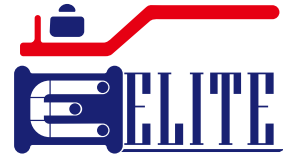

TOP ENTRY BALL VALVE

NO.	PART NAME	STANDARD MATERIALS			
		CARBON STEEL	ALLOY STEEL	STAINLESS STEEL	DUPLEX STEEL
1	BODY	A216 WCB	A217 WC6	A351 CF8M	A995 4A
2	SEAT RING	A105+ENP/A182 F6a/F304/F316/F51		A182 F316/F51	A182 F51/F53/F55
3	BALL	A105+ENP/A182 F6a/F304/F316/F51		A182 F316/F51	A182 F51/F53/F55
4	STEM	A182 F6a/F304/F316/17-4PH		A182 F316/F51	A182 F51/F53/F55
5	THRUST WASHER	PTFE/RPTFE/DEVLON			
6	BODY GASKET	SS+GRAPHITE/SS+PTFE			
7	BONNET O-RING	VITON/NBR/HNBR/FVMQ			
8	GLAND STUD	A193 B7	A193 B16	A193 B8(M)	
9	STEM O-RING	VITON/NBR/HNBR/FVMQ			
10	STEM PACKING	PTFE/GRAPHITE			
11	GLAND NUT	A194 2H	A194 4	A194 8(M)	
12	BONNET STUD	A193 B7	A193 B16	A193 B8(M)	
13	BONNET NUT	A194 2H	A194 4	A194 8(M)	
14	BEARING	SS+PTFE/SS+Nitriding			
15	THRUST WASHER	SS+PTFE			
16	THRUST WASHER	SS+PTFE			
17	STUFFING BOX	A105+ENP		A182 F316	A182 F51
18	GLAND GASKET	SS+GRAPHITE/SS+PTFE			
19	GLAND O-RING	VITON/NBR/HNBR/FVMQ			
20	DRAIN PLUG	CARBON STEEL		SATINLESS STEEL	
21	SEALANT FITTING	CARBON STEEL		SATINLESS STEEL	
22	BONNET	A216 WCB	A217 WC6	A351 CF8M	A995 4A
23	SPRING HOLDER RING	A105+ENP/A182 F6a/F304/F316/F51		A182 F316/F51	A182 F51/F53/F55
24	STEM KEY SCREW	A193 B7	A193 B16	A193 B8(M)	
25	STEM KEY	AISI 1045			
26	STUFFING BOX STUD	A193 B7	A193 B16	A193 B8(M)	
27	STUFFING BOX PIN	AISI 1065/SS410/SS304/SS316			
28	CONNECTION PLATE	A105+ENP	A182 F316	A182 F51	
29	BONNET PIN	SS410/SS304/SS316			

DESIGN FEATURES

- Sealant injection to stem and/or seat area.
- Metal seated or primary metal seat with secondary soft insert.
- Extended Bonnet for low or high temperature service.
- Extended Stem for underground installation.
- Locking & interlocking facilities.
- Drain and Vent connections with thread protection or valve(ball/gate..) vent & drain valve fitted.
- Pneumatic, Electric or Hydraulic Automation.
- Emergency Shut Down applications.

The material is according to ASTM Standard.

Model Denote:EFC=Elite Flow Control | 02=Size in inch | BV=Ball Valve | 1=150Lb | B=BW End | 5=Top Entry